

1

2

3

A

B

A

B

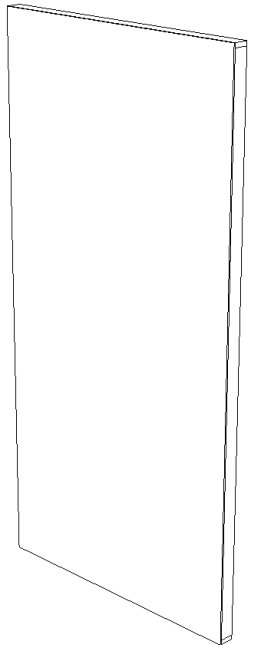

**HOLLYWOOD FLAT
FRONT
ISOMETRIC VIEW**

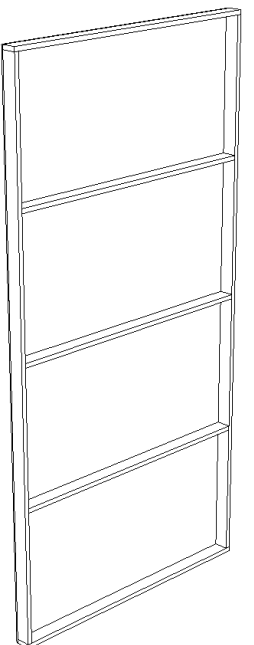

**HOLLYWOOD FLAT
REAR
ISOMETRIC VIEW**

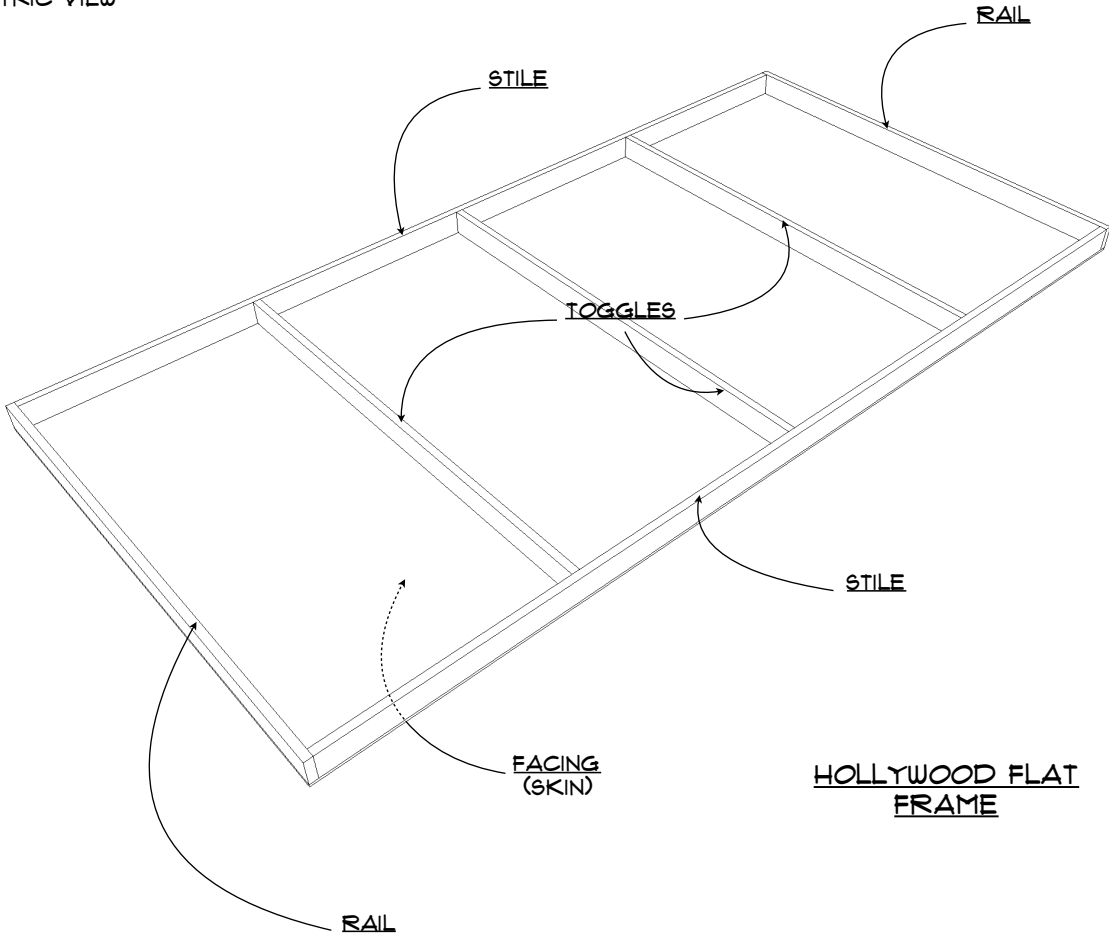

**HOLLYWOOD FLAT
FRAME**

Technical Director/Contact Information:	DANIEL CZYPIŃSKI DCZTEIN@CALSTATELA.EDU
Drawn By:	DANIEL CZYPIŃSKI
Revision Date:	

Notes:
 FRAME: USE 16 GAUGE, MEDIUM CROWN STAPLES, 1 1/2" DEPTH
 FACING: USE 18 GAUGE, NARROW CROWN STAPLES, 3/4" DEPTH

Project:	STOCK SCENERY: HOLLYWOOD STYLE FLAT
Director:	
Purpose:	INSTRUCTIONAL

Date: **SEPTEMBER 2016**

Scale: **NOT TO SCALE**

Plate #: **1
OF
6**

CUT LIST

- 1 - 1/4" LUAN @ 4' X 8'
- 2 - 1" X 3" PINE BOARDS @ 7' 10-1/2"
- 2 - 1" X 3" PINE BOARDS @ 4'
- 3 - 1" X 3" PINE BOARDS @ 3' 10-1/2"

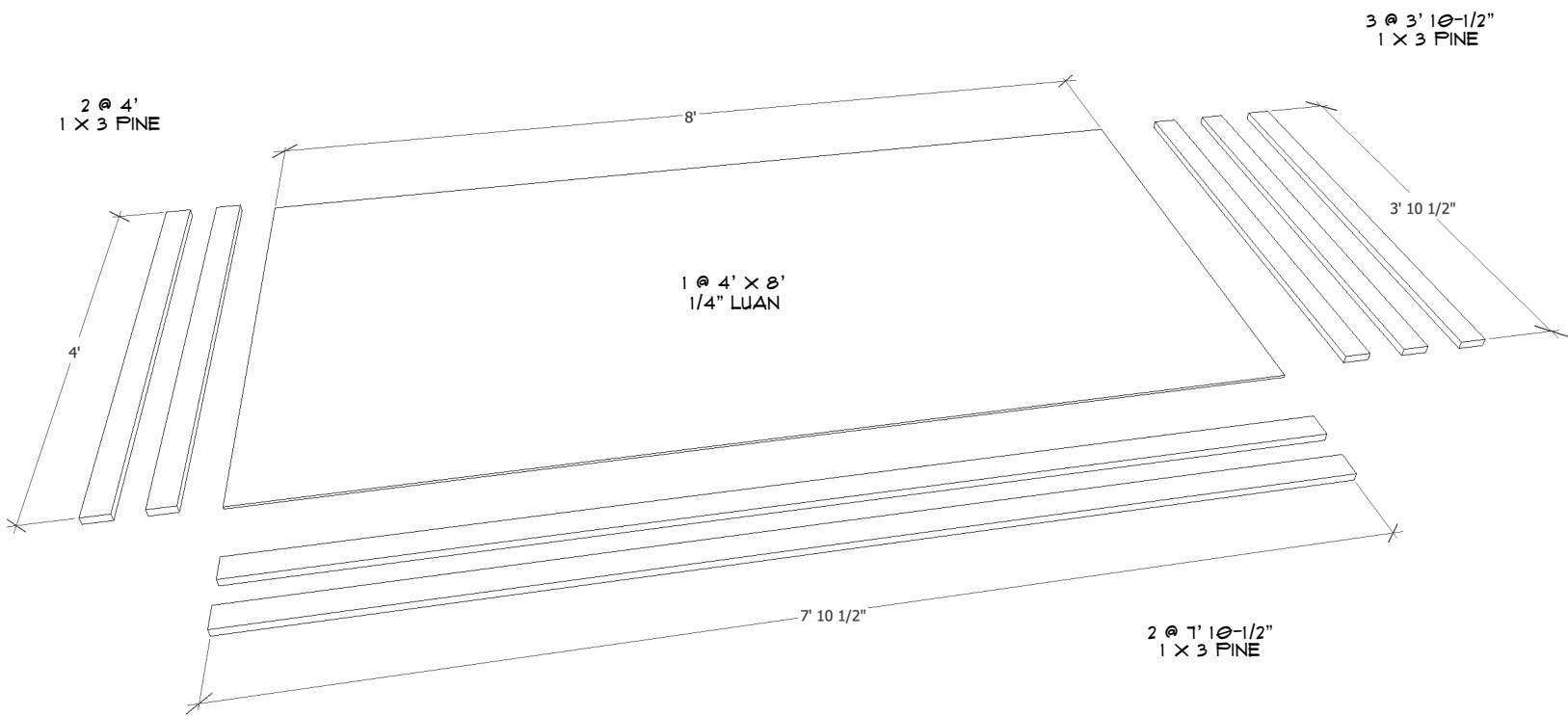

Technical Director/Contact Information: DANIEL CZYPIŃSKI DCZTEIN@CALSTATELA.EDU	Drawn By: DANIEL CZYPIŃSKI Revision Date:
Notes: FRAME: USE 16 GAUGE, MEDIUM CROWN STAPLES, 1 1/2" DEPTH FACING: USE 18 GAUGE, NARROW CROWN STAPLES, 3/4" DEPTH	
Project: STOCK SCENERY: HOLLYWOOD STYLE FLAT	Director: Purpose: INSTRUCTIONAL
Date: SEPTEMBER 2016	
Scale: NOT TO SCALE	
Plate #: 2 OF 6	

ASSEMBLY

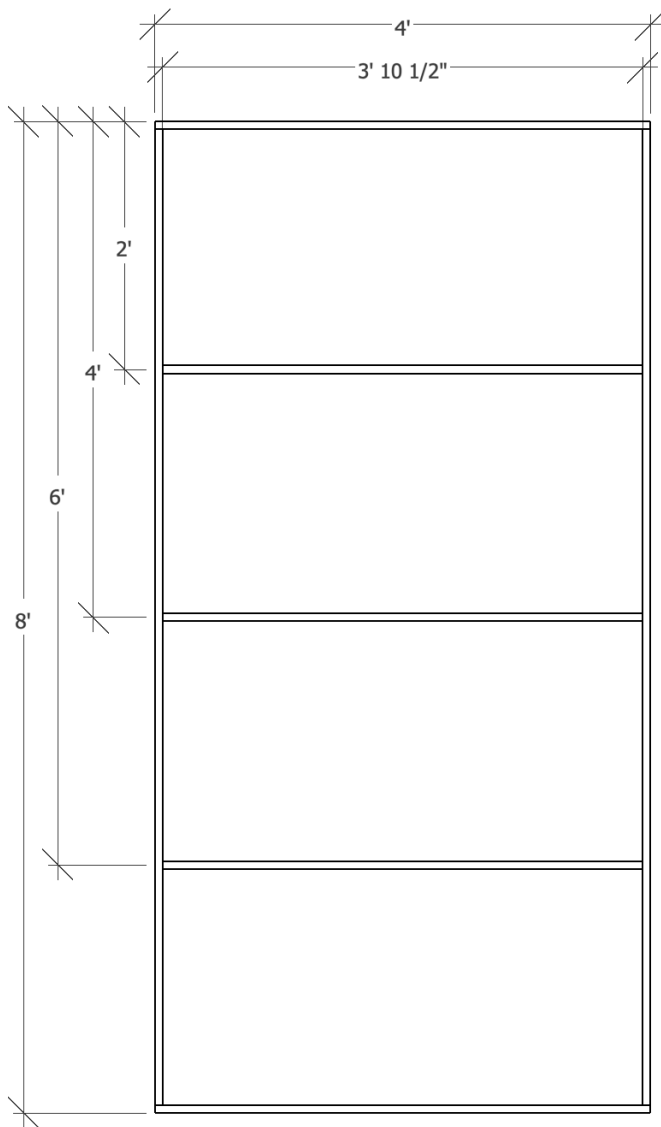

VIEW: REAR ELEVATION

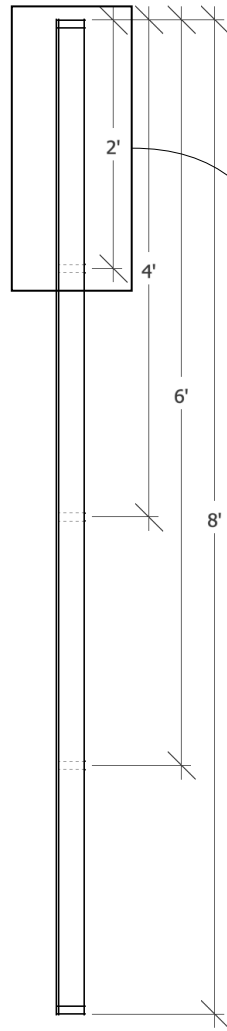

VIEW: SECTION

VIEW: DETAIL

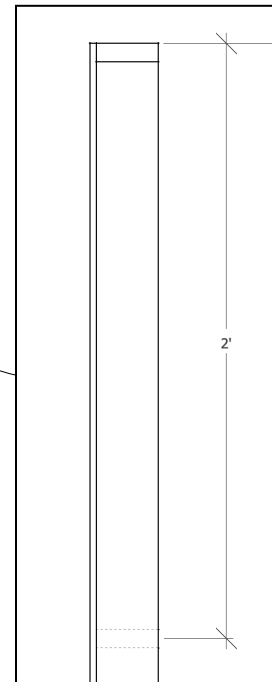

NOTE: TOGGLES ARE
POSITIONED @ 2'
ON CENTER

Technical Director/Contact Information: DANIEL CZYPIŃSKI DCZTEIN@CALSTATELA.EDU		Drawn By: DANIEL CZYPIŃSKI	Revision Date:
Notes: FRAME: USE 16 GAUGE, MEDIUM CROWN STAPLES, 1 1/2" DEPTH FACING: USE 18 GAUGE, NARROW CROWN STAPLES, 3/4" DEPTH			
Project: STOCK SCENERY: HOLLYWOOD STYLE FLAT	Director: DANIEL CZYPIŃSKI	Purpose: INSTRUCTIONAL	
Date: SEPTEMBER 2016			
Scale: NOT TO SCALE			
Plate #: 3 OF 6			

1

2

3

A

B

A

B

**BROADWAY FLAT
FRONT
ISOMETRIC VIEW**

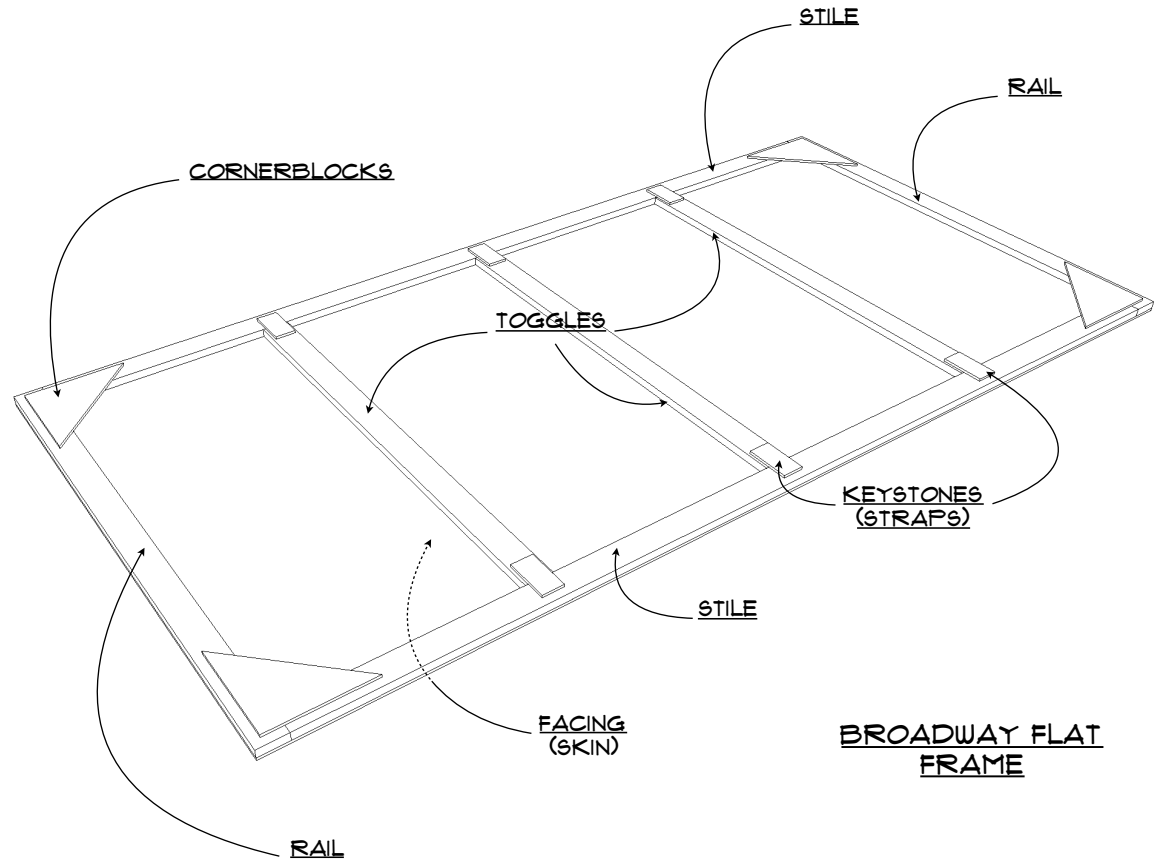
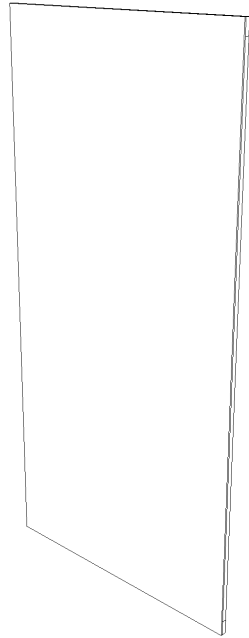

**BROADWAY FLAT
FRAME**

**BROADWAY FLAT
REAR
ISOMETRIC VIEW**

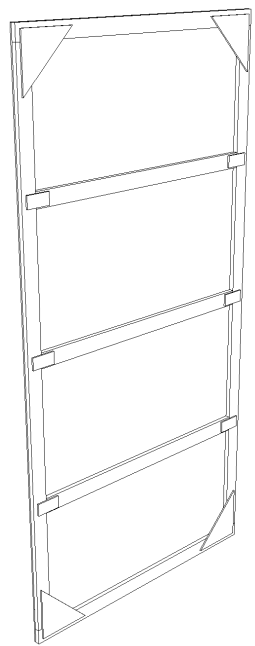

Technical Director/Contact Information:

DANIEL CZYPIŃSKI
DCZTEIN@CALSTATELA.EDU

Drawn By: DANIEL CZYPIŃSKI

Revision Date:

Notes:
FRAME: 1 1/2 GAUGE, WIDE CROWN
STAPLES: 5/8" DEPTH
FACING, CORNERSTONES &
KEYSTONES: 1 1/8 GAUGE, NARROW
CROWN STAPLES, 1/2" DEPTH

Project:
STOCK SCENERY:
BROADWAY STYLE FLAT

Director:

Purpose:
INSTRUCTIONAL

Date:
SEPTEMBER 2016

Scale:
NOT TO SCALE

Plate #:
6 OF 4

1

2

3

CUT LIST

- 1 - 1/4" LUAN @ 4' X 8'
- 2 - 1" X 3" PINE BOARDS @ 1 1"
- 2 - 1" X 3" PINE BOARDS @ 4'
- 3 - 1" X 3" PINE BOARDS @ 3' 1"
- 4 - 1/4" PLYWOOD @ 9" X 9"
- 6 - 1/4" PLYWOOD @ 2" X 4"

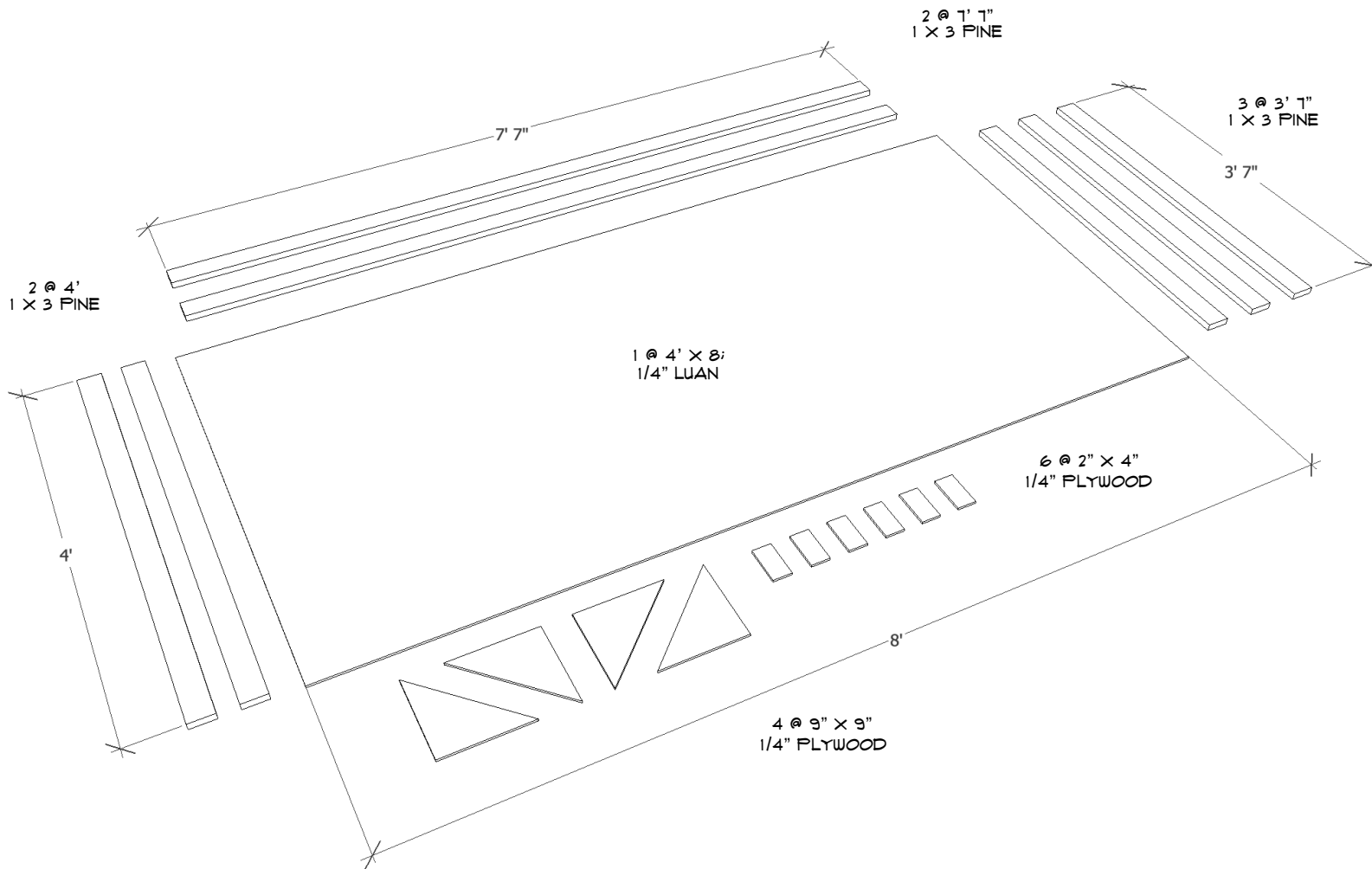

Technical Director/Contact Information:

DANIEL CZYPIŃSKI
DCZTEIN@CALSTATELA.EDU

Drawn By: DANIEL CZYPIŃSKI

Revision Date:

Notes:

FRAME: 16 GAUGE, WIDE CROWN
STAPLES, 5/8" DEPTH
FACING, CORNERSTONES &
KEYSTONES: 18 GAUGE, NARROW
CROWN STAPLES, 1/2" DEPTH

Project:

STOCK SCENERY:
BROADWAY STYLE FLAT

Director:

Purpose:

INSTRUCTIONAL

Date:

SEPTEMBER 2016

Scale:

NOT TO SCALE

Plate #:

6 of 11

A

A

B

B

ASSEMBLY

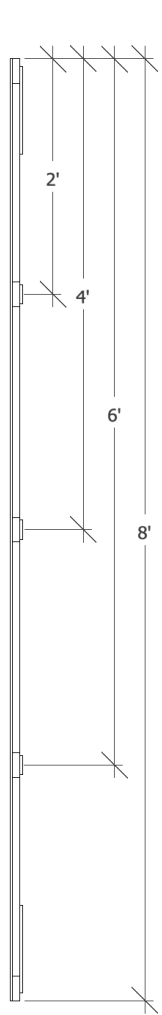

VIEW: SECTION

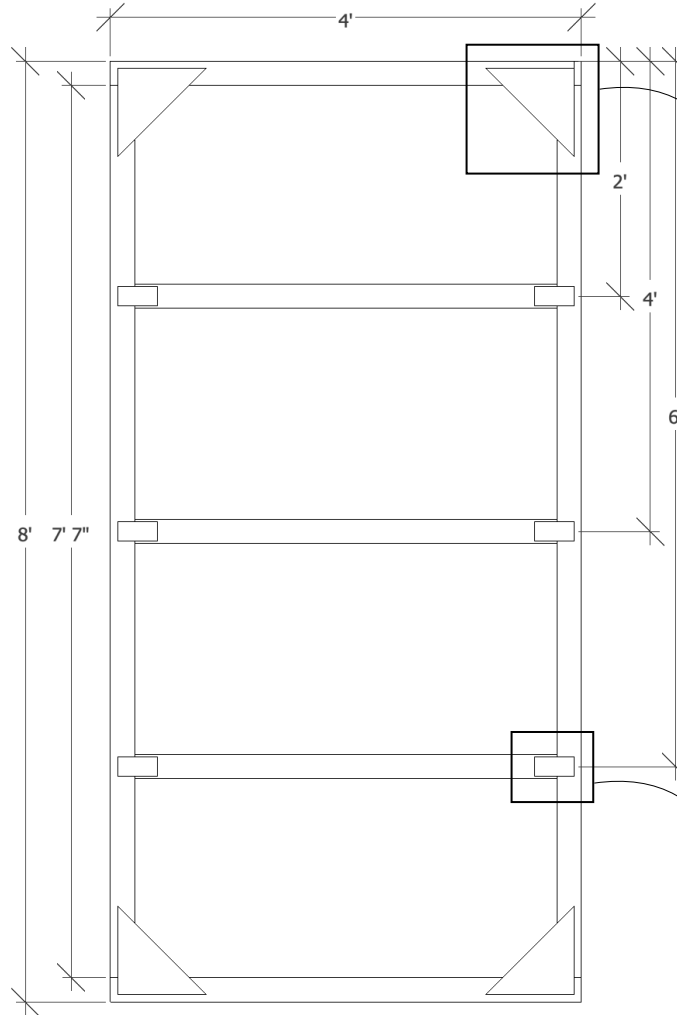

VIEW: REAR ELEVATION

NOTE: TOGGLES ARE
POSITIONED @ 2'
ON CENTER

VIEW: DETAIL

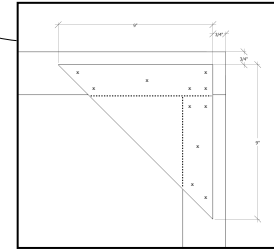

- NOTE:
- "X" MARKS STAPLE PATTERN
 - CORNERBLOCKS AND KEYSTONES ARE SET IN 3/4" FROM THE EDGE

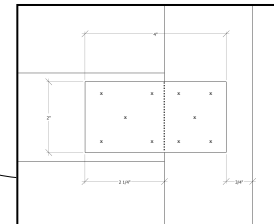

Technical Director/Contact Information:	DANIEL CZYPIŃSKI DCZTEIN@CALSTATELA.EDU
Drawn By:	DANIEL CZYPIŃSKI
Revision Date:	

Notes:

FRAME: 16 GAUGE, WIDE CROWN STAPLES, 5/8" DEPTH
FACING, CORNERSTONES & KEYSTONES: 18 GAUGE, NARROW CROWN STAPLES, 1/2" DEPTH

Project:	STOCK SCENERY: BROADWAY STYLE FLAT
Director:	
Purpose:	INSTRUCTIONAL

Date: SEPTEMBER 2016

Scale: NOT TO SCALE

Plate #:
6
OF
6